

**WARNING!** Buyer/user assumes all responsibility for safety and proper use not in accordance with the directions and safety labels.



## FEATURE

- **Energy Efficient**
- **Fully Submersible**
- **Multi-Purpose**
- **Quiet Running**
- **Oil-Free Motor**
- **For Fresh & Saltwater Environments**

ViaAqua® submersible water pumps, the energy efficient and versatile water pump. These utility pumps can be used for wet/dry filtration, water circulation, protein skimmers and/or fountains. Enhanced motor design and magnetic rotor technology makes these units energy efficient and silent, yet are powerful and reliable.

## AVAILABLE MODELS

Item No.	Description	UPC No.
VA-180	5 watt PowerHead Pump	2113 4
VA-360	8 watt PowerHead Pump	1874 5
VA-480	11 watt PowerHead Pump	1875 2
VA-1300	24 watt PowerHead Pump	1876 9
VA-1800	24 watt PowerHead Pump	2115 8
VA-2300	41 watt PowerHead Pump	2114 1
VA-2600	46 watt PowerHead Pump	1877 6
VA-3600	80 watt PowerHead Pump	1879 0
VA-4900	113 watt PowerHead Pump	1880 6

# PowerHead PUMP

## ViaAqua



outlet. The DRIP LOOP is that part of the cord that hangs below the receptacle. See diagram

- Prior to maintenance to a fountain or water feature unplug the pump.
- Do not use the pump if the pump and/or power cord has been damaged. Disregard product

*This product may contain chemicals known to the state of California to cause cancer and/or birth defects or other reproductive harm. Wash your hand after handling this product.*

*It is your sole responsibilities to verify that the plug and the receptacle are clean and free of moisture and salt build up at all times. The receptacle must be free of water, salt, calcium, magnesium and dust. Failure to do so can cause fire, damage to property, permanent damage to the product and personal injury not limited to loss of life.*

*Do not plug into extension cord/power strip.*

*A drip loop must be used when plugging all electrical aquarium devices. A drip loop is that*



*part of the cord hanging below the receptacle.*

*The national code requires that a GFCI (Ground fault circuit interrupter) be used in the branch circuit supplying all power to water pumps and electrical aquarium equipment. If you do not have a GFCI, have an electrician install one prior to operating any aquarium component.*

**Additional Safety Precautions & Warnings:**

Age Recommendation: 18 years or over. Not a toy. Not intended for use by children without direct adult supervision. As the user of this product, you are solely responsible for operating it in a manner that does not endanger yourself and others or result in damage to the product or the property of others.

## IMPORTANT

Failure to maintain and/or operate the pump according to the manufacturer's guidelines and directions will cause pump not to work properly or may completely malfunction. This could cause the loss of fish, plants and animals. It is the full responsibility of the consumer to maintain both their aquariums and pump to insure a healthy aquatic environment!

## WARNING AND SAFEGUARD

Please read and follow these important safeguards and safety guidelines.

- ViaAqua® pump must be operated fully submersed at all times.
- Never operate a ViaAqua® pump with an electronic wave maker or timing device. As such devices will cause permanent damage to the pump and/or demagnetize the impeller.
- When operating the pump inside an aquarium, The main filter strainer must be installed failure to do so will damage to the impeller and/or pump.
- When operating a pump inside a pond or fountain, a large pre-filter must be used. Failure to use its will cause damage to the impeller and/or pump.

- Routine maintenance is required to ensure the maximum performance and the longevity of the ViaAqua® pump. See maintenance guidelines.
- Prior to maintenance on any electrical aquarium appliance or maintenance to the aquarium, you must unplug all electrical aquarium devices.
- The use of a surge suppressor is strongly recommended.
- The pump must be plugged directly to a GFCI outlet only. If a GFCI outlet is not present consult an electrician.
- Do not plug the pump into any type of extension cord, power supply and/or power strip. The pump is only to be plugged directly to a GFCI outlet.
- A drip loop must be arranged by the user for each cord connecting an aquarium appliance to a GFCI

## SPECIFICATION:

Item No.	Wattage	Dimension (L x W x H) inch	Flow Rate	Tubing ID (in)	Max Head
VA-180	5 watt	2.25 x 1.25 x 1.7	80 GPH	½	2 ft.
VA-360	8 watt	3 x 1.8 x 2.35	152 GPH	½	3.5 ft.
VA-480	11 watt	3 x 1.8 x 2.35	200 GPH	½	4.1 ft.
VA-1300	24 watt	4.25 x 2.25 x 2.75	370 GPH	¾	6 ft.
VA-1800	24 watt	6 x 2.5 x 3.5	480 GPH	¾	6 ft.
VA-2300	41 watt	6 x 2.5 x 3.5	600 GPH	¾	6 ft.
VA-2600	46 watt	7 x 3 x 3.6	740 GPH	¾	7.8 ft.
VA-3600	80 watt	7.5 x 3.1 x 4.25	1055 GPH	¾ or 1	13 ft.
VA-4900	113 watt	7.5 x 3.1 x 4.25	1321 GPH	¾ or 1	14 ft.

## LIMITED WARRANTY

Commodity Axis Inc.® warrants that ViaAqua® PowerHead Pump is free from defects for a period of one year from the initial date of purchase shown in the original cash register receipt. Commodity Axis Inc.® disclaims all other warranties of merchantability and/or fitness for a particular purpose. Although this limited warranty gives you specific rights, you may have other rights that may vary from state to state. This Warranty is void if the failure of the ViaAqua® Pump or any part, sealant or component there of is due to (i) misuse, (ii) tampering, (iii) negligence, (iv) misapplication, (v) abuse, (vi) accident and/or (vii) failure to properly (a) maintain, (b) clean, (c) pre-filter, (d) reassemble, (e) clean and/or use the ViaAqua® PowerHead Pump with a Ground Fault Circuit Interrupter (G.F.C.I.).

## CONSUMER REMEDIES

Commodity Axis Inc.® entire Liability and your sole exclusive remedy are either repair or replacement of the ViaAqua® PowerHead Pump only if you return the defective ViaAqua® PowerHead Pump directly to Commodity Axis Inc.® with the original receipt in this original box along with \$15.00 for shipping and handling. Do not send the chiller by insured mail. The ViaAqua Pump may be sent by UPS requiring signature upon arrival. Any replacement ViaAqua® PowerHead Pump will be warranted for remaining of the original warranty period. In not event shall any shipping charges be reimbursed.

In no event will Commodity Axis Inc. be liable for any consequential or incidental damages including, but not limited to, loss of life, personal injury, property damage, damaged equipment, lost profits, lost wages, lost savings, lost income, etc. arising out of the use of the ViaAqua® PowerHead Pump. Some states do not allow for the limitation or exclusion of liability for incidental or consequential damages, so the above exclusion may not apply to you.

## RETURNS

Please contact our service center at (888) 838-3882 or fax (888) 989-0878 to arrange repair and/or replacement. Please allow 4-6 weeks for all returns. Commodity Axis, Inc.® cannot ship nor respond to a P.O. Box address.

## WARRANTY CARD

Please go to our website, to download Warranty Card. <http://www.viaaquaocleanpure.com/main/resources.html>. Fill out this warranty card and mail it with PROOF OF PURCHASE within 15 days of purchase

## APPLICATIONS:

### VA-180 TO VA-480

#### APPLICATION 1: CIRCULATION

1. Choose discharge adapter
2. Use the provided suction cups or pump hanger to secure the pump on the back wall of the aquarium
3. The back wall of the aquarium needs to be free of algae and deposits for the suction cup to adhere well.
4. Position the pump where it will be fully submersed at all times
5. Plug the unit directly to a GFCI outlet

#### APPLICATION 2: UNDERGRAVEL FILTER

1. Follow the manufacture's guidelines on the installation of the under gravel filter.
2. Remove the main housing strainer and attach the undergravel filter strainer to the intake of the pump. Then, attach the undergravel filter adapter to the undergravel filter strainer. See diagram for output options
3. Position the pump where it will be fully submersed at all times. This may take some modifications to the uplift tube of the undergravel filter.
4. Use the provided suction cups or pump hanger to secure the pump on the back wall of the aquarium. The back wall of the aquarium needs to be free of algae and deposits for the suction cup to adhere well.

## PART LIST:

### VA-180

1. Pump housing
2. Impeller
3. Shaft and bushings
4. Impeller endcap
5. Large intake strainer
6. ½" discharge adapter
7. Control valve
8. Duck bill
9. Discharge adapter with venturi
10. Air line tubing with silencer
11. Undergravel filter strainer and adapter
12. Output elbow
13. Suction cups

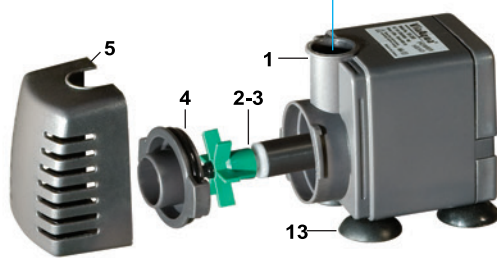

CIRCULATION

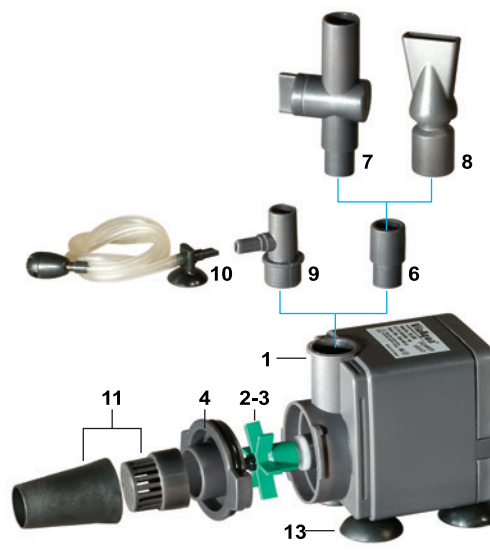

UNDERGRAVEL FILTER

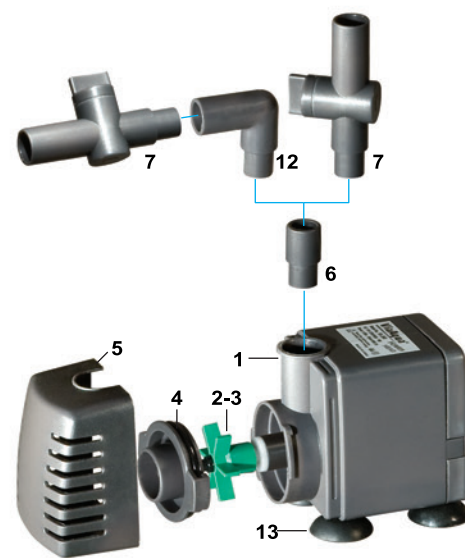

FOUNTAIN

**NOTE:** If air and water is desired to be discharge from the pump, remove the air stopper and connect the air tubing and silencer to the nipple on the discharge adaptor. Place tubing outside the water.

Verify that there is no gravel under the undergravel filtering plates as the suction of the pump can cause the gravel to be pulled into the intake of the pump, causing permanent damage to the impeller/pump.

#### APPLICATION 3: FOUNTAIN

Verify that the pump size fits the application without dramatically restricting the flow. Consult your local dealer or manufacturer's guidelines for the proper size and model of ViaAqua® pump.

Connect tubing to the discharge of the pump and do not reduce the tubing diameter. When connecting flexible tubing to the intake of the pump, use a hose clamp to insure water tightness. Make sure there is no water leaking at the fittings.

When operating the pump for water circulation, fountain, and waterfalls. The large intake strainer needs to be installed. Pump must be fully submersed at all times.

Plug directly to a GFCI outlet

## PART LIST:

### VA-360 TO VA-480

1. Pump housing
2. Impeller
3. Shaft and bushings
4. Impeller endcap
5. Large intake strainer
6. ½" discharge adapter
7. Control valve
8. Duckbill
9. Discharge adapter with venturi
10. Airline tubing with silencer
11. Undergravel filter strainer & adapter
12. Output elbow
13. 3/8" discharge adapter
14. Suction cups
15. Pump Hanger

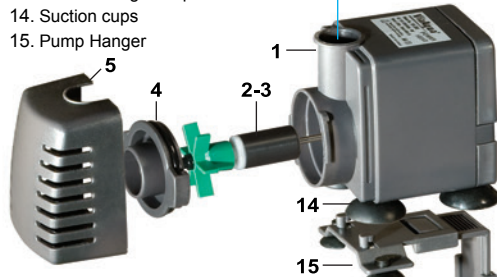

CIRCULATION

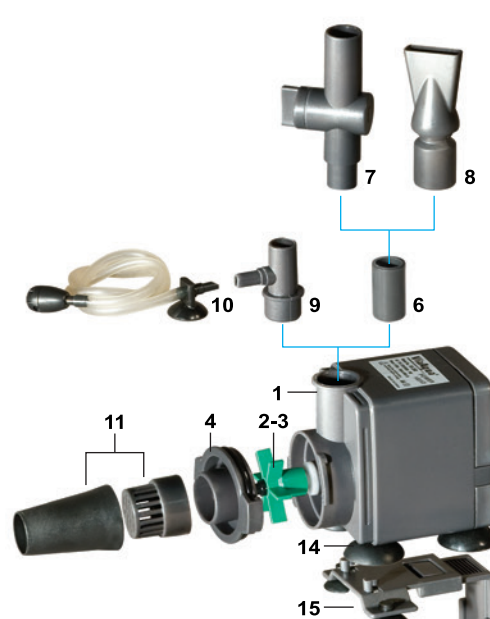

UNDERGRAVEL FILTER

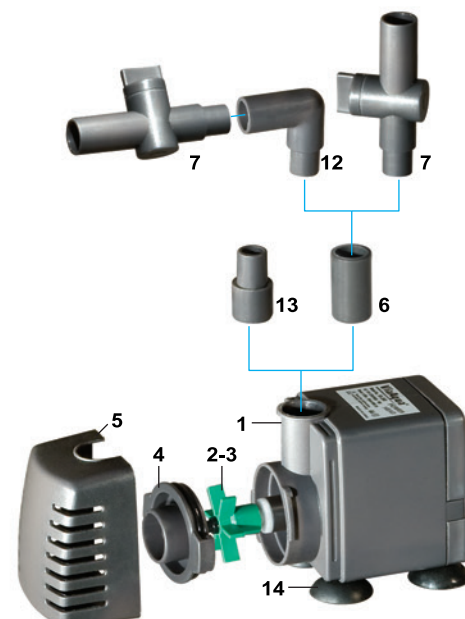

FOUNTAIN



**APPLICATION:**  
**VA-1300 TO VA-4900**

**APPLICATION 1: CIRCULATION**

Choose discharge adapter  
Use the provided suction cups or pump hanger to secure the pump on the back wall of the aquarium.  
The back wall of the aquarium needs to be free of algae and deposits for the suction cup to adhere well.  
Position the pump where it will be fully submerged at all times  
Plug the unit directly to a GFCI outlet

**APPLICATION 2: UNDERGRAVEL FILTER**

**NOTE: Only applicable to Models VA1300-2600**  
Follow the manufacturer's guidelines on the installation of the under gravel filter.  
Remove the main housing strainer and attach the undergravel filter strainer to the intake of the pump.  
Then, attach the undergravel filter adapter to the undergravel filter strainer. See diagram for output options.  
Position the pump where it will be fully submerged at all times. This may take some modifications to the uplift tube of the undergravel filter.  
Use the provided suction cups or pump hanger to secure the pump on the back wall of the

aquarium. The back wall of the aquarium needs to be free of algae and deposits for the suction cup to adhere well.  
**NOTE:** If air and water is desired to be discharge from the pump, remove the air stopper and connect the air tubing and silencer to the nipple on the discharge adaptor. Place tubing outside the water.  
Verify that there is no gravel under the undergravel filtering plates as the suction of the pump can cause the gravel to be pulled into the intake of the pump, causing permanent damage to the impeller/pump.

**APPLICATION 3: FOUNTAIN**

Verify that the pump size fits the application without dramatically restricting the flow. Consult your local dealer or manufacturer's guidelines for the proper size and model of ViaAqua® pump.  
Connect tubing to the discharge of the pump and do not reduce the tubing diameter. When connecting flexible tubing to the intake of the pump, use a hose clamp to insure water tightness. Make sure there is no water leaking at the fittings.  
When operating the pump for water circulation, fountain, and waterfalls. The large intake strainer needs to be installed. Pump must be fully submerged at all times.  
Plug directly to a GFCI outlet

**APPLICATION 4: WET/DRY FILTRATION SYSTEMS, PROTEIN SKIMMER & SUMPS**

Viaqua water pump is designed to run completely submerged in water. Do not operate pump outside of water! This pump should be submerged in water before connecting to a power source. Use the flow chart to determine the proper water flow and tubing size. Do not reduce water flow of the pump by more than 15% using a control valve  
Read and follow all warning and safeguards.  
1. Connect the suction cup bracket to the pump  
2. Choose discharge options  
3. Secure the tubing with a hose clamp  
4. Verify that the pump will be operated fully submerged at all times  
5. Submerge pump in water and plug directly to a GFCI outlet.

**PROTEIN SKIMMERS:**

Refer to the protein skimmer manufacture guidelines for applying the pump to the specific skimmer.  
**NOTE: Every skimmer manufacture uses individual way of connecting the pump directly to their protein skimmer consult manufactures guidelines for proper installation.**

**Helpful Hints:**

1. The use of a float valve will help ensure a consistent water level and ensure the pump will operate fully submerged at all times.
2. If the pump is making excess noise verify that the pump is free standing and is not vibrating against the wall of the sump.
3. Excess noise can be caused using too small of tubing restricting flow or restricting flow with a valve by more than 15%

**IMPORTANT: Do to the design of Wet/Dry Filtration and Sumps, there is a high amount of evaporation and failure maintain a consistent water level or the daily addition of top off water will cause the pump to operate without being fully submerged. If the pump is not operated fully submerged imminent malfunction to the pump will occur, thus resulting in loss of live stock and/or injury or loss of life. If the pump is not operated fully submerged at all times the warranty is void.**

10

11

12

13

**PART LIST:**

**VA-1300 TO VA-2300**

1. Pump housing
2. Impeller
3. Shaft and Endcaps
4. Impeller endcap & lock nut
5. Large intake strainer

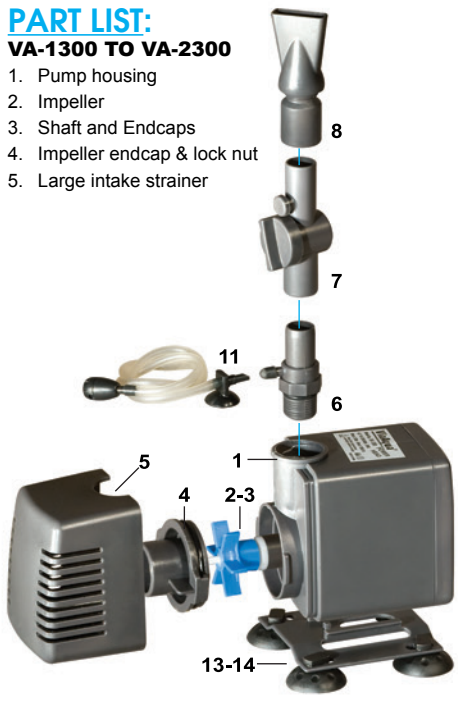

CIRCULATION

6. Slip discharge adapter with venturi
7. Control valve
8. Duck bill
9. 3/4" barbed discharge adapter
10. Barbed intake adapter
11. Airline tubing with silencer

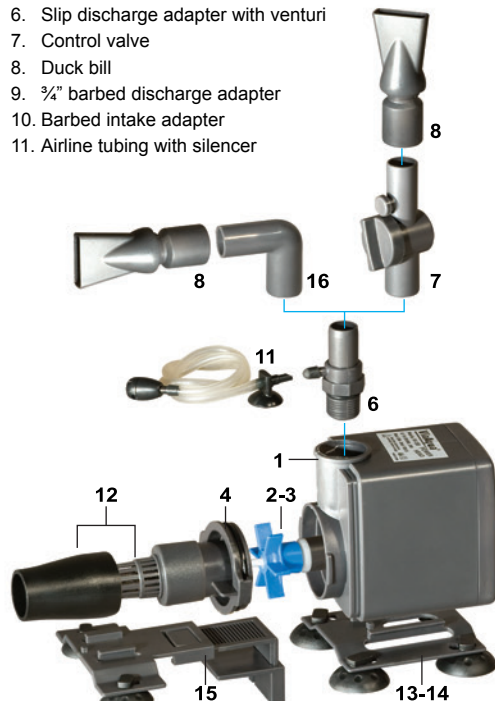

UNDERGRAVEL FILTER

12. Undergravel filter strainer & adapter
13. Suction cup adapter
14. Suction cups
15. Pump hanger
16. Output elbow

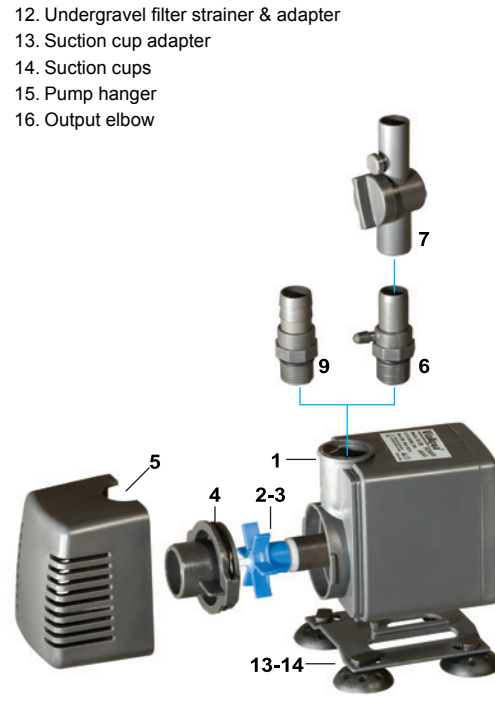

FOUNTAIN

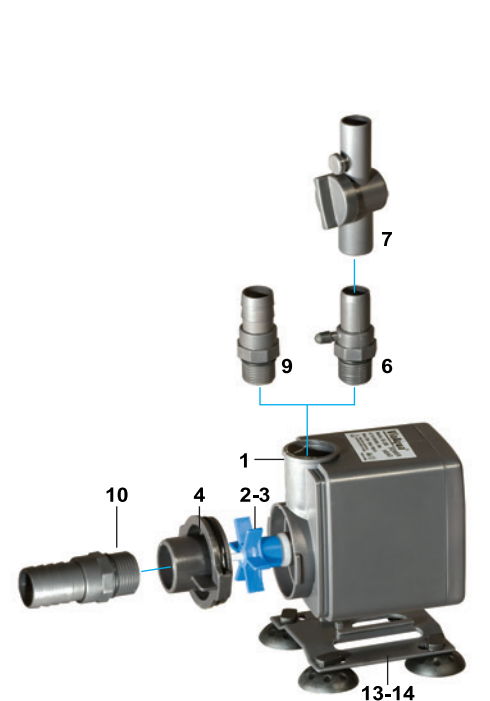

WET/DRY FILTRATION SYSTEMS, PROTEIN SKIMMER & SUMPS

**PART LIST:**

**VA-2600 TO VA-3300**

1. Pump housing
2. Impeller
3. Shaft and bushing
4. Impeller well cover & lock nut
5. Intake strainer
6. Large intake strainer

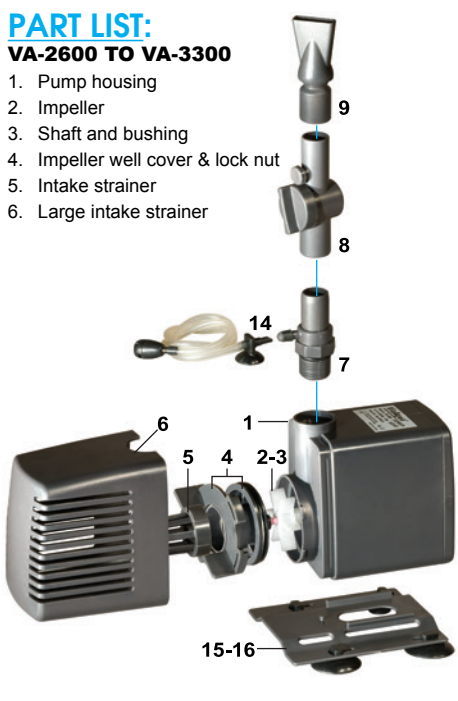

CIRCULATION

7. Slip discharge adapter with venturi
8. Control valve
9. Duck bill
10. Output elbow
11. 3/4" barbed discharge adapter
12. 1" barbed intake adapter

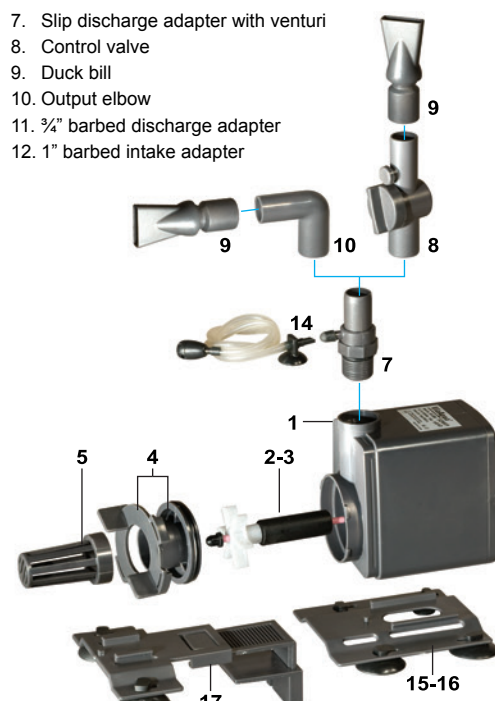

UNDERGRAVEL FILTER

13. Intake elbow
14. Airline tubing with venturi
15. Suction cup bracket
16. Suction cups
17. Pump hanger

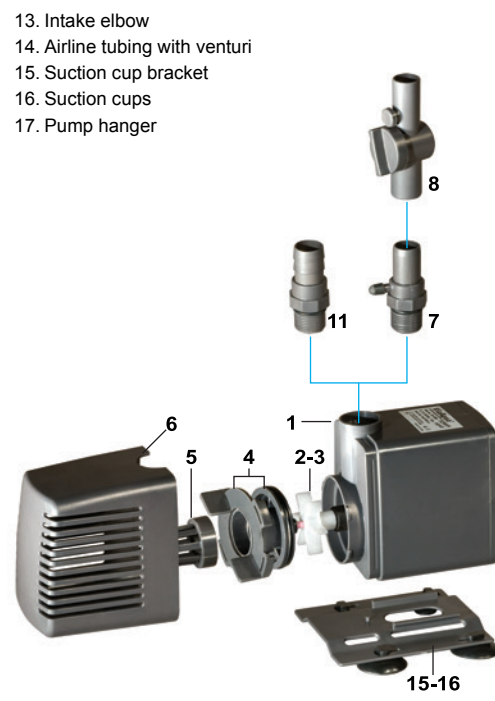

FOUNTAIN

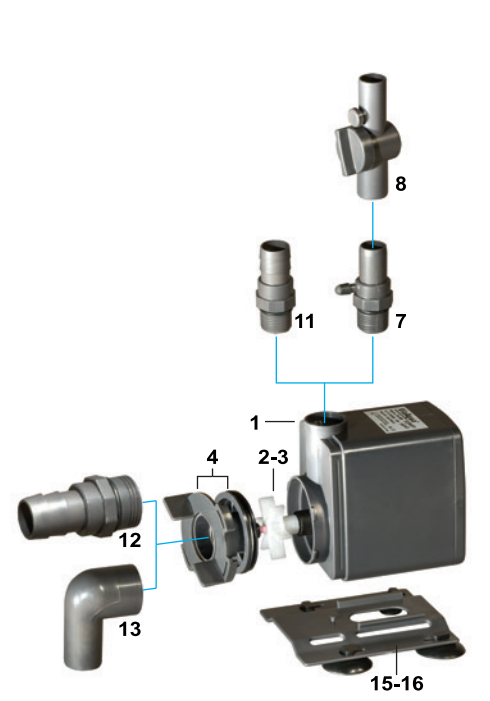

WET/DRY FILTRATION SYSTEMS, PROTEIN SKIMMER & SUMPS

**PART LIST:**

**VA-3600 TO VA-4900**

1. Pump housing
2. Impeller
3. Shaft and bushing
4. Impeller well cover & lock nut

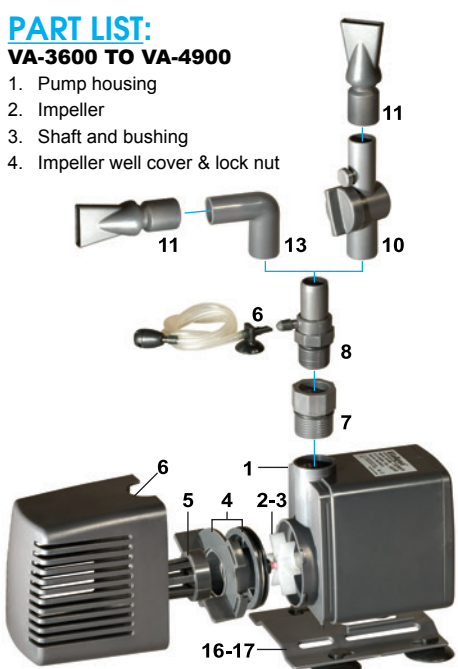

CIRCULATION

5. Intake strainer
6. Large intake strainer
7. Threaded pump adapter
8. Slip discharge adapter with venturi
9. Airline tubing with silencer
10. Control valve
11. Duck bill

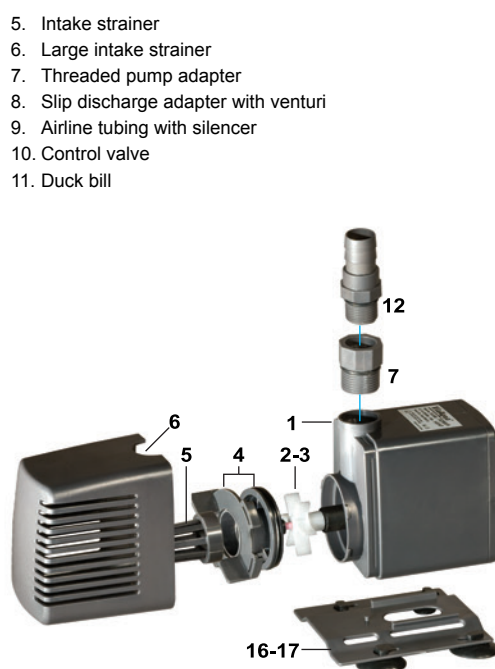

UNDERGRAVEL FILTER

12. 1" Barbed discharge adapter
13. Output elbow
14. 1" barbed intake adapter
15. Intake elbow
16. Suction cup bracket
17. Suction cups

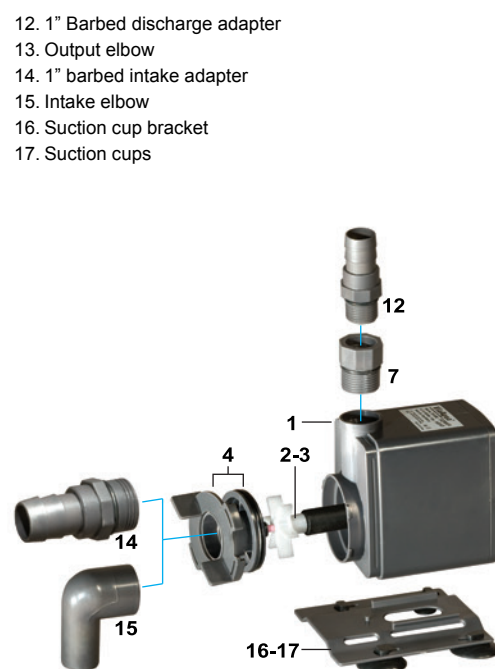

FOUNTAIN

**MAINTENANCE**

To insure a properly operating pump: Clean pump, impeller and intake strainer every 3 weeks. Failure to do so will cause premature failure of the pump.

Disconnect the pump from the power supply prior to removing the pump from the water.

1. Remove either the intake filter strainer.
2. Remove the impeller well cover.
3. Once the impeller well cover is removed, slide both the impeller and shaft out of the main body of the pump and clean well. Do not use any soap detergents during cleaning.
4. After the impeller and shaft are cleaned, use a small brush to clean inside of the motor housing.
5. Reassemble above parts and your ViaAqua® pump is again ready to use. Confirm that all the washer and bushing a reassembled properly. Failure to do so will cause permanent damage to the pump.
6. Replace the impeller if there are any signs of damage or excess wear.